

Movement of personnel, equipment and materials from the Loading Dock to the work site is via Elevator #2 located at the Mauka end of the building (see Plot Plan), and approximately 30 feet from the dock and work areas. Elevator dimensions are: 9' 0" H x 6' 9" W x 6' 0" D

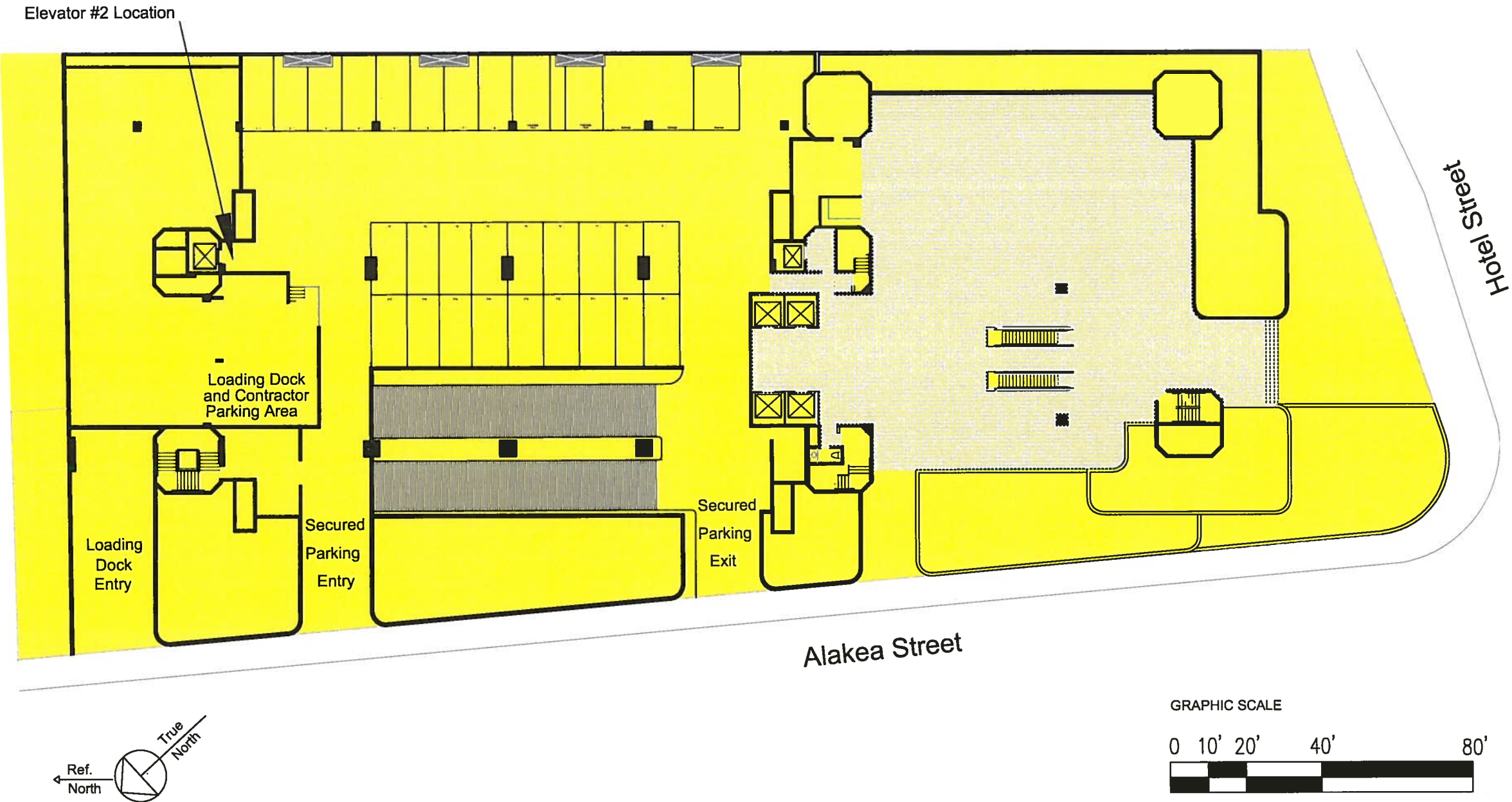

Project/Contract Limits - Highlighted Area

Movement of personnel, equipment and materials from the Loading Dock to the work site is via Elevator #2 located at the Mauka end of the building (see Plot Plan), and approximately 30 feet from the dock and work areas. Elevator dimensions are: 9' 0" H x 6' 9" W x 6' 0" D

Elevator #2 Location

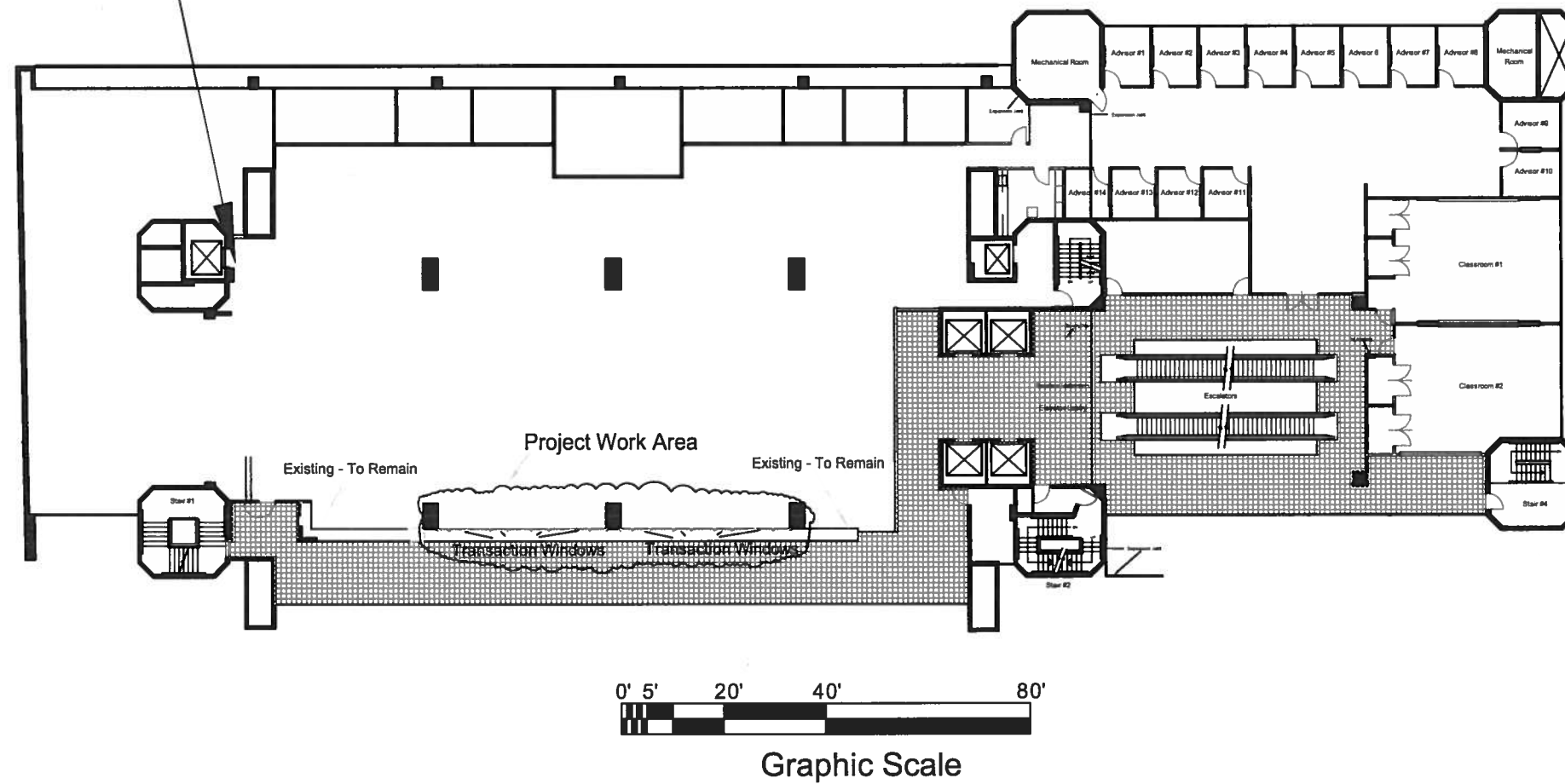

Kauikeauoli Hale - 3rd Floor Work Area

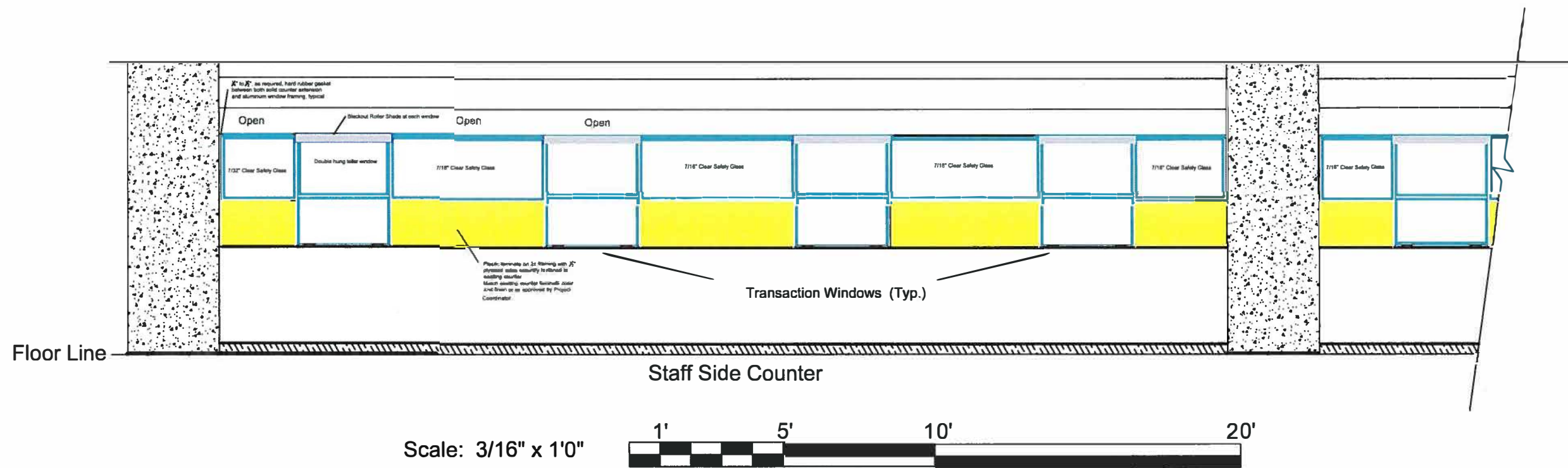

Kauikeauoli Hale - 3rd Floor Transaction Windows - 4 Typical in Each Bay, 8 Total  
(Staff Side of the Counter)

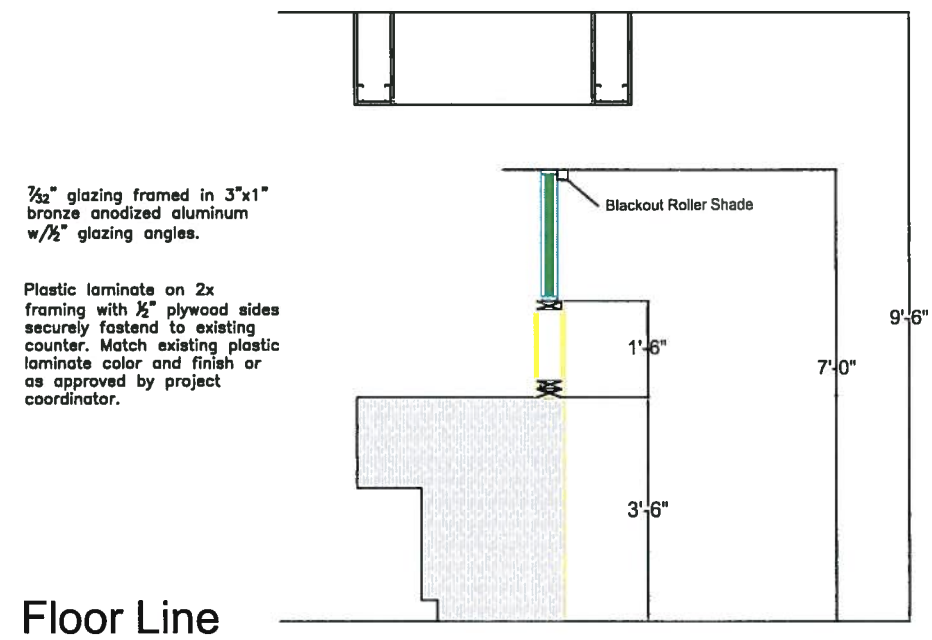

Detail A-2 Kauikeauoli Hale - Transaction Windows  
Section Details

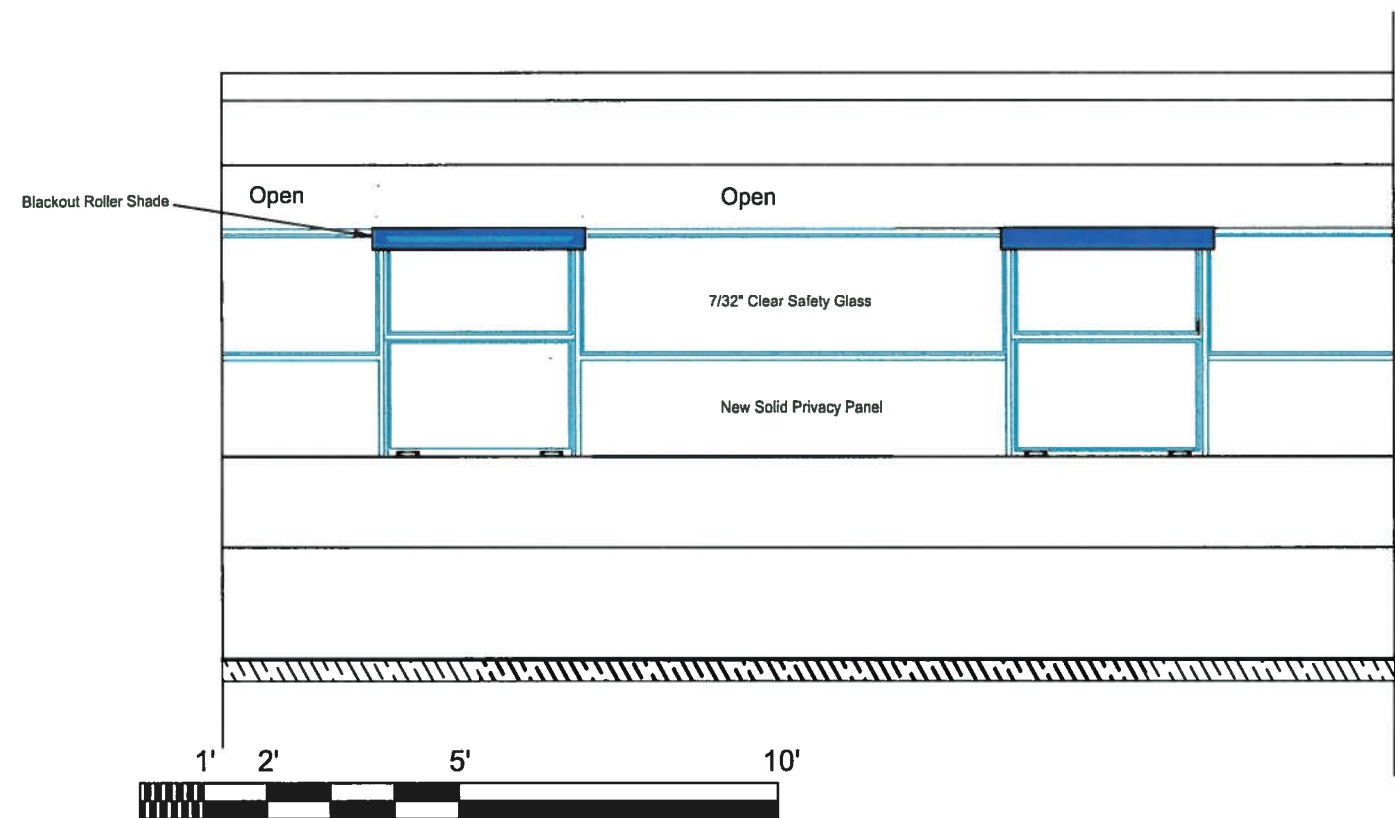

Detail - Kauikeauoli Hale - Bali Blackout Roller Shades  
at  
Transaction Windows