

Movement of personnel, equipment and materials from the Loading Dock to the work site is via Elevator #2 located at the Mauka end of the building (see Plot Plan), and approximately 30 feet from the dock and work areas. Elevator dimensions are: 9' 0" H x 6' 9" W x 6' 0" D

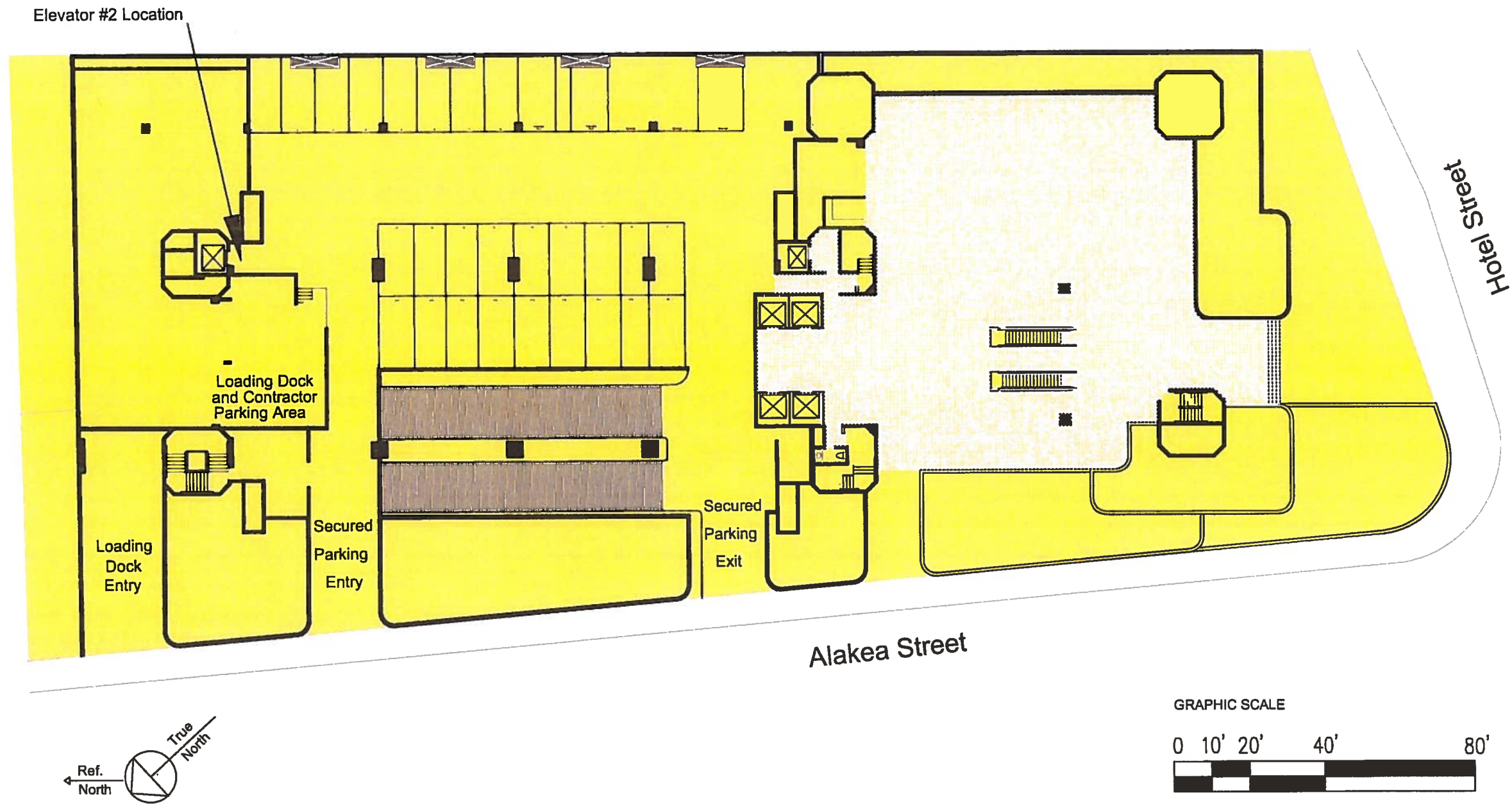

Project/Contract Limits - Highlighted Area

Movement of personnel, equipment and materials from the Loading Dock to the work site is via Elevator #2 located at the Mauka end of the building (see Plot Plan), and approximately 30 feet from the dock and work areas. Elevator dimensions are: 9' 0" H x 6' 9" W x 6' 0" D

Elevator #2 Location

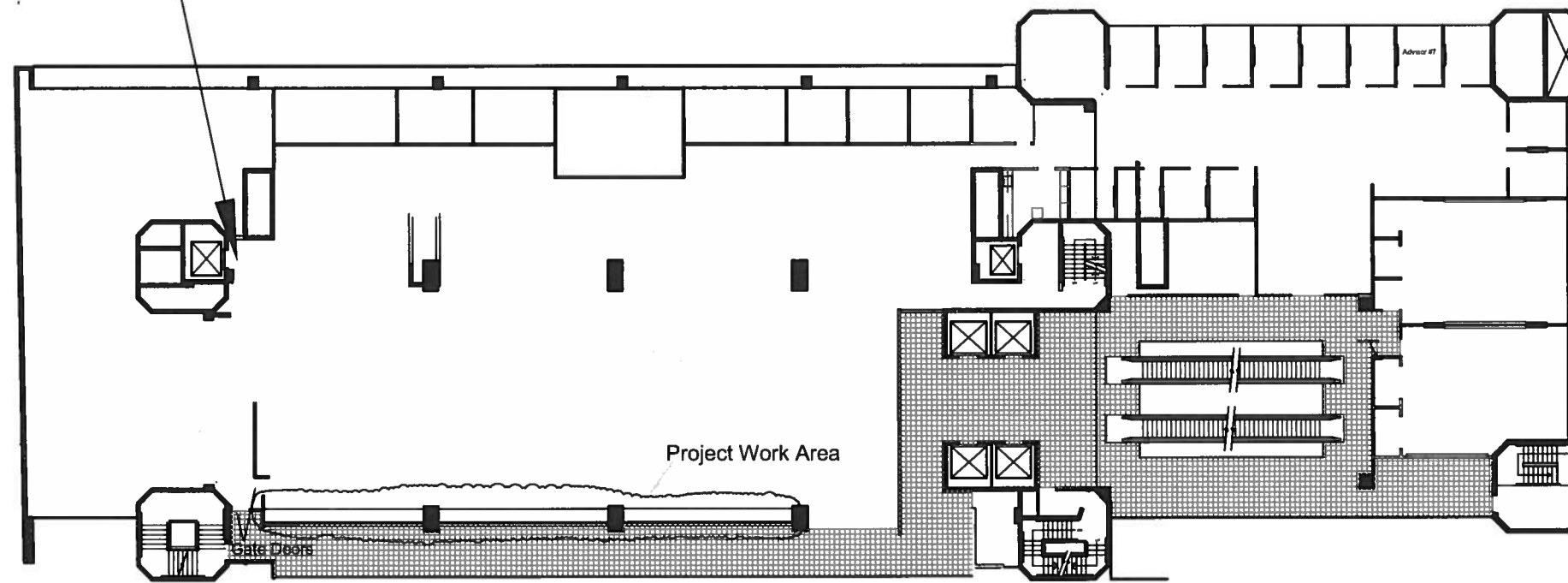

Graphic Scale

Kauikeauoli Hale - 2nd Floor Work Area

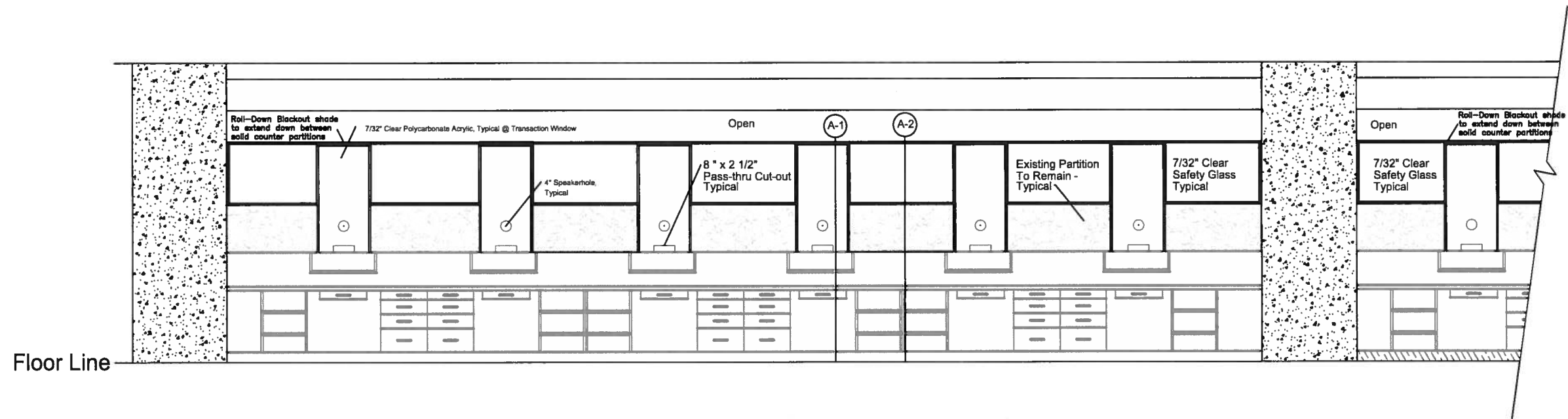

Partial Elevation - Showing 7 Windows - 6 Typical in Each Bay, 18 Total
 Kauikeauoli Hale - 2nd Floor Transaction Windows (Staff Side of the Counter)



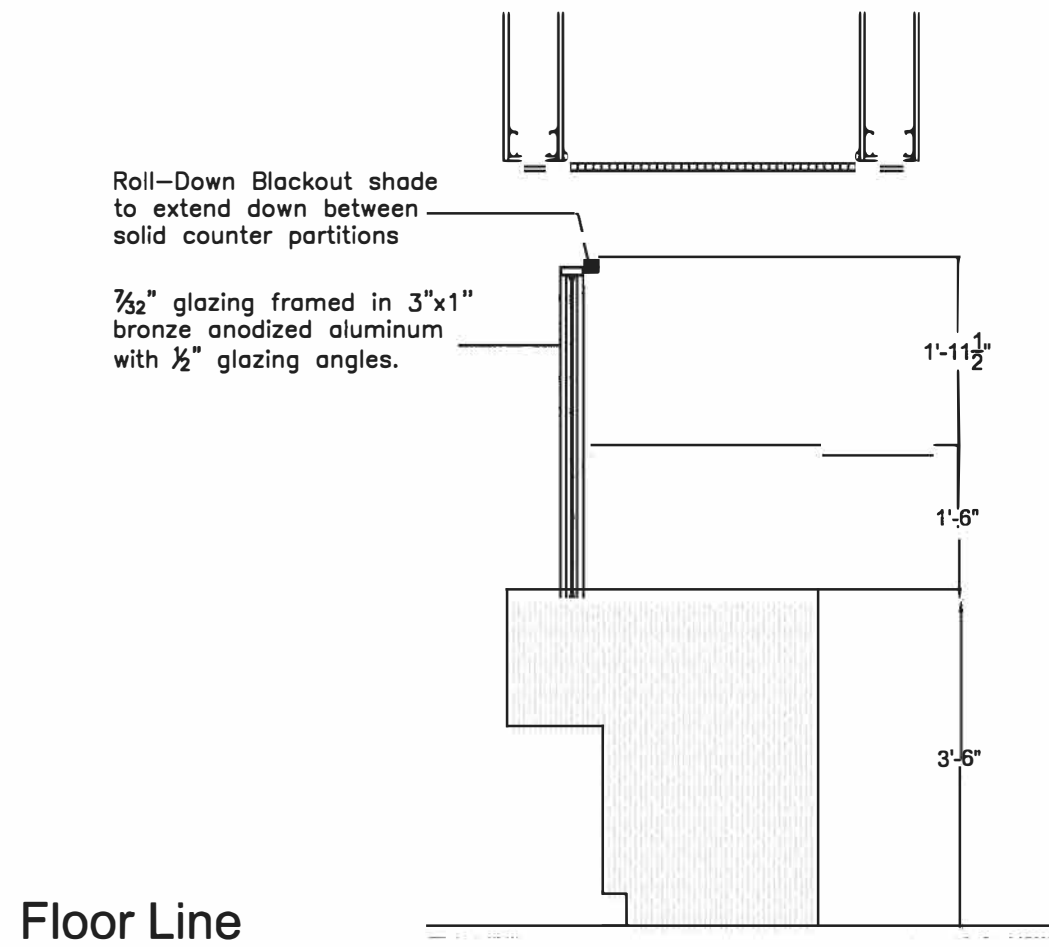

Detail A-1 Kauikeauoli Hale - Second Floor Section at Transaction Window

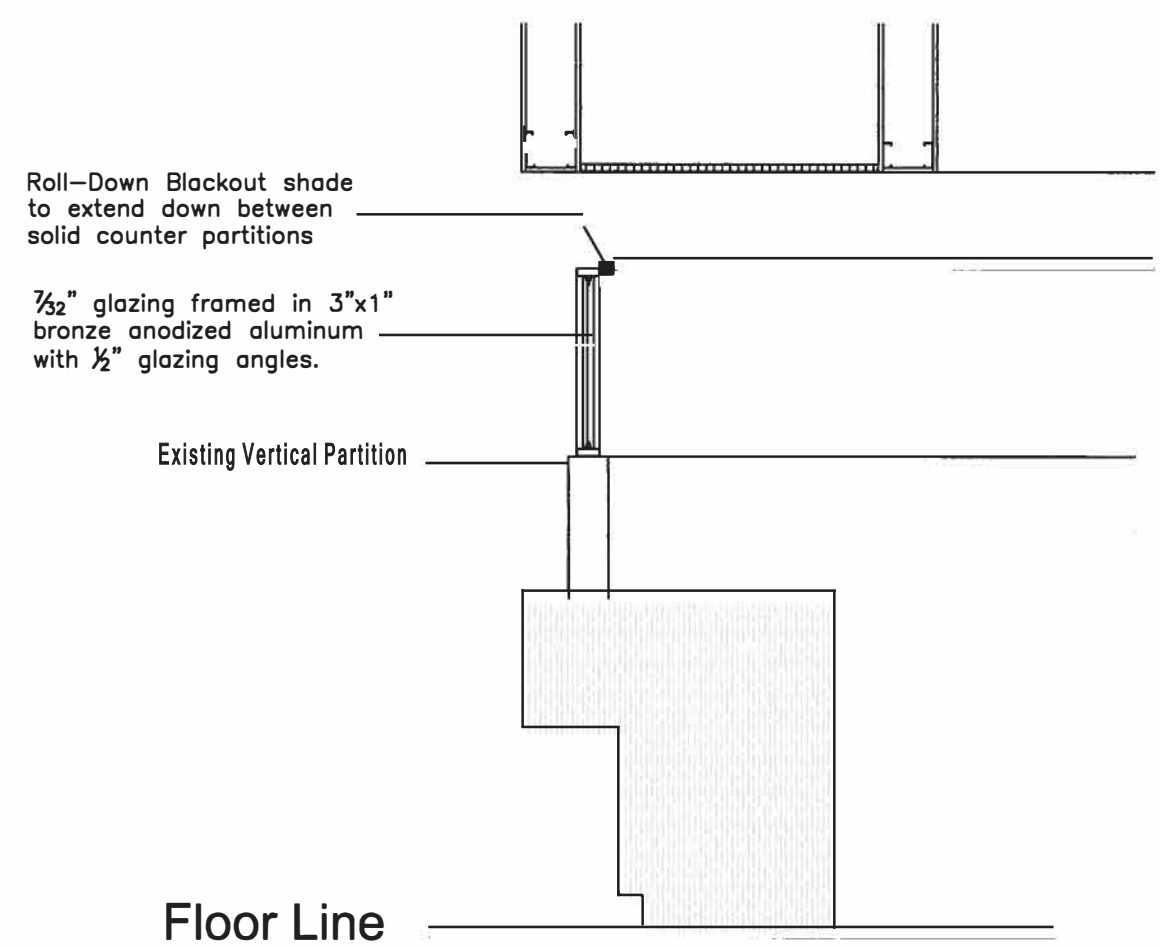
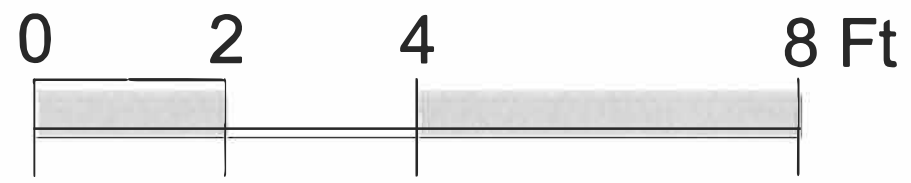

Detail A-2 Kauikeauoli Hale - Second Floor Section at New Glazing Above Existing Partition to Remain

